

# Electric Actuator for Plug Doors

For limo-buses,  
shuttles and  
midi-buses.



## Plug Door operation without compromise.

- ▶ No heavy, costly air compressor
- ▶ No inconvenient air lines
- ▶ No high-maintenance components
- ▶ No complex adjustments

Vapor Bus International, the leading power door system manufacturer in North America, offers an innovative actuator for medium-duty buses. This compact, rugged unit is designed specifically for limo-buses, shuttles and midi-buses.

Using technology proven in decades of demanding transit vehicle service, the Vapor Electric Door Actuator provides convenient, reliable operation for swing plug doors. Doors can be opened and closed by a seated driver with the flick of a switch.

An electric prime mover transmits motion to the door shaft and boomerang arms via a rugged sector gear and connecting rod, limiting door forces to just the right amount, regardless of door position. A powered latching mechanism secures the door in the closed position and assures positive sealing. Optional sensors can confirm that the door is open or closed.

For simple installation, convenient operation and long-term reliability, the Vapor Electric Door Actuator is the clear choice.

### Door Opening Sequence

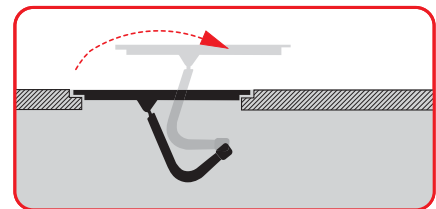

Door closed

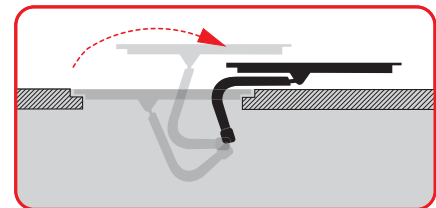

Door open



Mechanical latching mechanism secures the door in the closed position. Easy manual operation in the event of power failure.

The BEST keeps getting BETTER

# Electric Actuator for Plug Doors

## FEATURES

- Maintenance-free gear motor with proven 250,000 cycle life
- Electric operation eliminates the cost and weight of an air compressor and the inconvenience of air piping
- Emergency release enables manual opening of doors if electric power is lost
- Compact package minimizes intrusion into passenger space

## TECHNICAL SPECIFICATIONS

- **Operating voltage:** 12VDC nominal
- **300 watt maximum power requirement**
- **Normal operating current:** 4 amps
- **Normal stall current:** 16 amps
- **Motor torque on pinion:** 100 lbs./in. - lbf
- **Maximum torque (door shaft):** 1,200 lbs./in. - lbf
- **Minimum transferred torque:** 830 lbs./in. - lbf
- **Release force on emergency handle:** 20 lbs. max.
- **Recommended door shaft rotation:** 90°
- **Door opening time:** 2 - 2.5 seconds @ 70°F (non-adjustable)
- **Door closing time:** 2 - 2.5 seconds @ 70°F (non-adjustable)
- **Operating temperature:** -40°F to +145°F
- **Envelope size:** (operator only) 14"w x 13"d x 5"h
- **Weight:** (operator only) 10.5 lbs.
- **Design life:** 250,000 cycles
- **Optional Limit Switches:**
  - Door fully closed
  - Door fully open
- **Optional Electronic Control**



1010 Johnson Drive  
 Buffalo Grove, Illinois 60089 USA  
 Phone: 847.777.6400  
 Fax: 847.520.2222  
 Email: vaporbusinfo@wabtec.com  
 www.vapordoors.com

Bulletin No. 54-5003 9-2008 Printed in U.S.A.

U.S. and foreign patents issued and/or pending are applicable to the products described and illustrated herein. Vapor and Vapor Bus International are registered trademarks of the Wabtec Corporation. Vapor reserves the right to discontinue products or change product specifications or designs at any time without notification.

